

1.	Nomenclature/Part No./GIG Number	Pin/Bell Crank/24-4206-270/315567
2.	Year of Production/Source	1984/M/S ANTONOV COMPANY
3.	Fleet/Sub System/Wpn system	AN-32/NOSE WHEEL STEERING FOLLOW UP SYSTEM
4.	Technical Applicability/Broad Purpose	NOSE WHEEL STEERING FOLLOW UP SYSTEM
5.	Technical Specifications	
6.	Publication Details (attach as separate sheets)	IPC 032.50.21 ITEM 32 FIG 1 PAGE 5
7.	Photograph of equipment	
8.	Brief Description	
9.	Classification of equipment- LRU/Testers/Ground equipment/Role equipment, Electrical, Electronics, Mechanical, Software based etc.)	Non Mand
10.	Previous Repair History	NIL
11.	Criticality (Priority I, II or III)	Priority II
12.	Requirement: Repair or Indigenization or both?	Indigenization
13.	Quantity Required (One time/Annual)	01 (ONE TIME)
14.	Sample Applicability	Sample available
15.	Scale/Deficiency	NIL
16.	If deficient- How deficiency is being plugged?	Cannibalisation
17.	SPOC details item/fleet wise	SPE ISC, 1 BRD, AF
18.	Draft QTS with major testing requirement (If already designed)	(To be generated by vendor in consultation with RCMA
19.	Any Other Relevant Information	

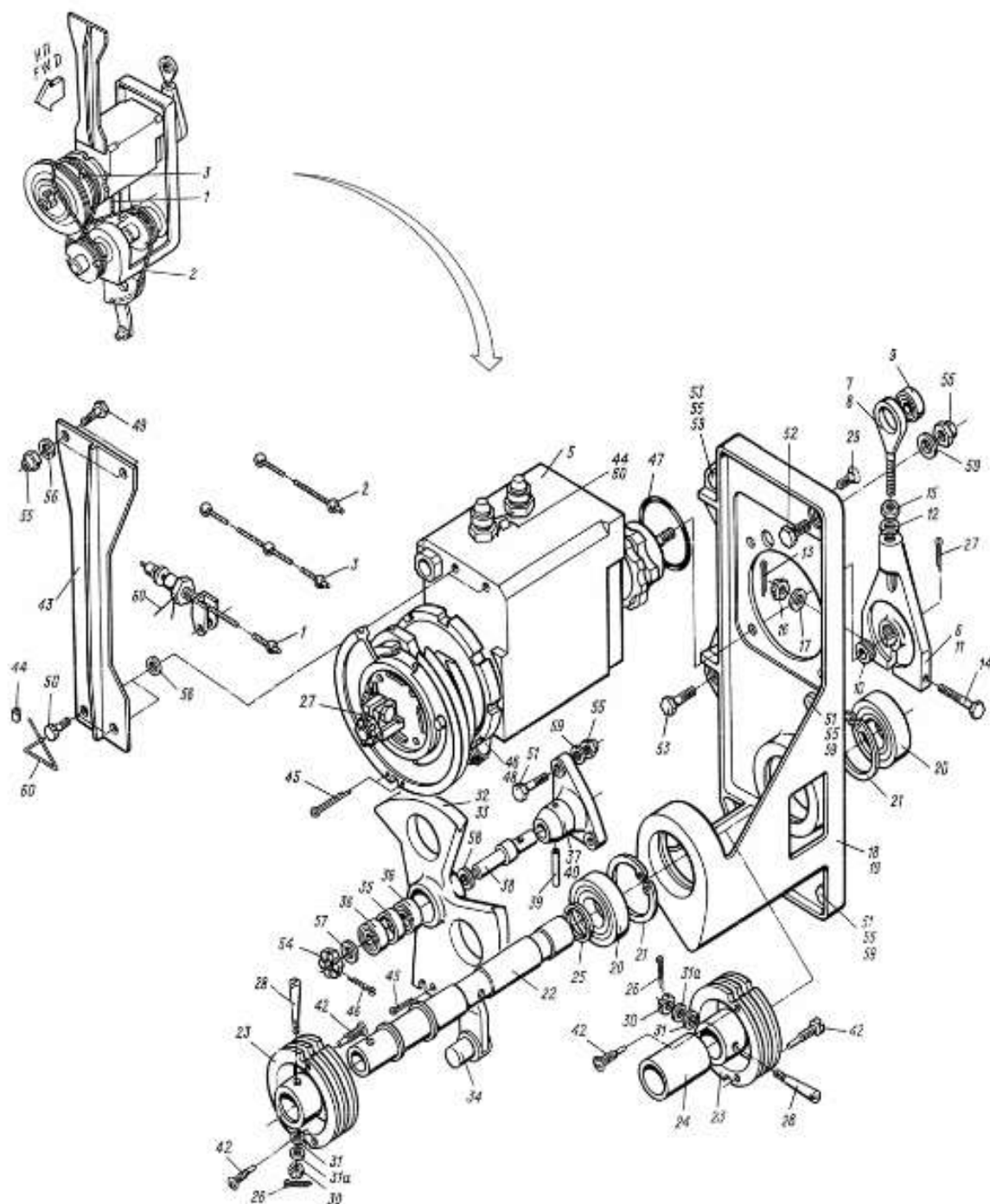

Рис. 1. МОНТАЖ СИСТЕМЫ СЛЕЖЕНИЯ
Fig. 1. FOLLOW-UP SYSTEM INSTALLATION